

Educational Travel to Japan

Kanagawa Prefecture 

Hakone, Kamakura, Yokohama



Overview of Kanagawa Prefecture

Located to the south of Tokyo, Kanagawa Prefecture has a population of about 9.1 million, which is the second largest in Japan following Tokyo Prefecture. We not only boast flourishing industries, such as automobiles and robotics, but are also blessed with abundant nature, being surrounded by the ocean and mountains. We have rich contents in various fields, including learning and experiencing contents necessary for school trips focusing on “industries,” “history,” “culture and art,” “nature,” and “sports,” as well as tourism contents. We are also easily accessible from both major gateways to Tokyo, Haneda and Narita airports, as well as from other major cities in Japan, including Tokyo and Osaka, with highly-developed public transit systems and expressways. Offering rich contents and an opportunity to stay in Japan safely and securely, we are looking forward to your visit to Kanagawa Prefecture.

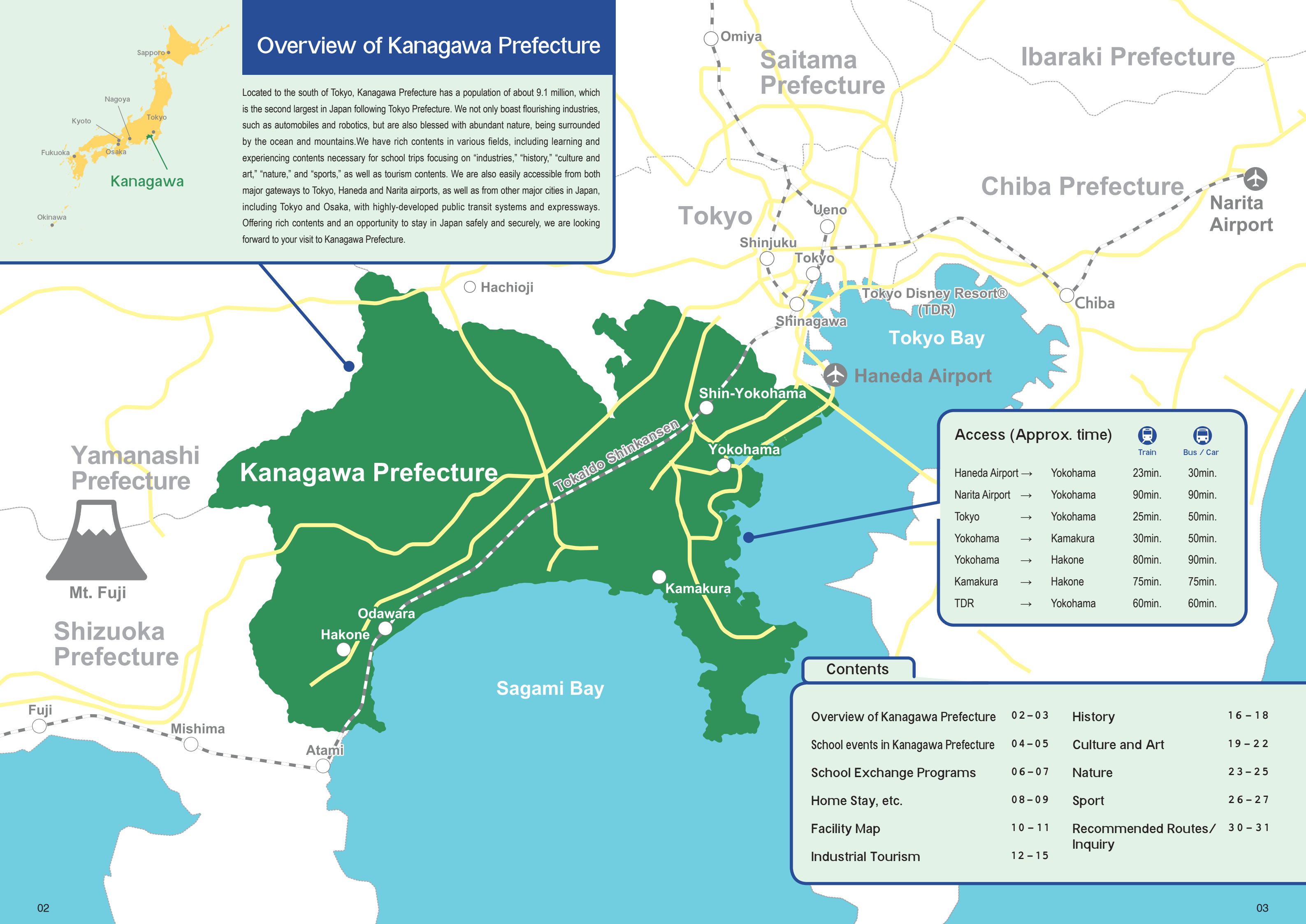

Access (Approx. time)

| | |  Train |  Bus / Car |
|------------------|----------|--|--|
| Haneda Airport → | Yokohama | 23min. | 30min. |
| Narita Airport → | Yokohama | 90min. | 90min. |
| Tokyo → | Yokohama | 25min. | 50min. |
| Yokohama → | Kamakura | 30min. | 50min. |
| Yokohama → | Hakone | 80min. | 90min. |
| Kamakura → | Hakone | 75min. | 75min. |
| TDR → | Yokohama | 60min. | 60min. |

















Contents

| | | | |
|--------------------------------------|---------|-----------------------------|---------|
| Overview of Kanagawa Prefecture | 02 - 03 | History | 16 - 18 |
| School events in Kanagawa Prefecture | 04 - 05 | Culture and Art | 19 - 22 |
| School Exchange Programs | 06 - 07 | Nature | 23 - 25 |
| Home Stay, etc. | 08 - 09 | Sport | 26 - 27 |
| Facility Map | 10 - 11 | Recommended Routes/ Inquiry | 30 - 31 |
| Industrial Tourism | 12 - 15 | | |

School Events in Kanagawa Prefecture (High school)

| | | | | | |
|---|---|--|---|---|--|
| January Winter holiday (late Dec. - early Jan.) College/university entrance exams | February College/university entrance exams High school entrance exams Final exams | March Graduation ceremony Spring holiday (late Mar. - early Apr.) Entrance ceremony | April Spring holiday (late Mar. - early Apr.) Entrance ceremony | May "Golden Week" holiday Sports day | June Final exams |
| July Final exams Summer holiday (late Jul. - end of Aug.) | August Summer holiday (late Jul. - end of Aug.) | September Sports day Cultural festival Final exams | October Sports day Cultural festival School excursion | November School excursion | December Final exams Winter holiday (late Dec. - early Jan.) |

Calendar for weather, flower blossoms, and events

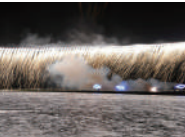
| | January | February | March | April | May | June | July | August | September | October | November | December |
|--|---|----------|---|--|---|--|------|---|-----------|--|----------|----------|
| Average temperature (degrees Celsius) | 5.9 | 6.2 | 9.1 | 14.2 | 18.3 | 21.3 | 25.0 | 26.7 | 23.3 | 18.0 | 13.0 | 8.5 |
| Blooming season  | Peony (Jan. - mid-Feb.)  | | Cherry blossom (mid-Feb. - early Apr.)  | | Rose (May)  | Hydrangea (mid-Jun. - mid-Jul.)  | | Cosmos (mid-Sept. - late-Oct.)  | | Japanese maple autumn foliage (early Nov. - mid-Dec.)  | | |
| | Field mustard (Jan. - late Mar.)  | | | Azalea (mid-Apr. - late May)  | | Sunflower (mid-Jul. - around Aug. 20)  | | | | | | |
| Events  | Enoshima Jewel of Shonan Festival (late Nov.-mid Feb.)  | | | Kamakura Festival (early - Apr.- mid Apr.)  | | Shonan Hiratsuka Tanabata Festival (early Jul.)  | | Tsurugaoka Hachimangu Annual Festival (mid Sep.)  | | Hakone Daimyo Procession (early Nov.)  | | |
| | | | | Yokohama Port Festival (early Jun.)  | | Atsugi Ayu Fireworks Festival (early Aug.)  | | | | | | |

How to respond to emergency situations

【Theft and Loss】
Report the theft/loss to the local police and obtain a certification of theft/loss from them. If you lose something on a train, bus, or taxi, contact the company that operates the train, bus, or taxi.

Theft/loss of passport
Contact the embassy or consular office of your country to cancel your missing passport and obtain an emergency passport or a travel document for return to your country.

Emergency Contacts
When a crime or incident occurs, call 110 for police.
To report a fire and/or ask for help/ambulance, call 119 for fire department.

【Disaster】
● **Earthquakes**
If you feel an earthquake, stay calm and protect yourself. Do not start running in a hurry, but act calmly. Watch out for any toppling/falling objects; protect your head with something like a hand bag.

● **Tsunami**
After an earthquake, a tsunami may occur. Do not go close to the waterfront or low land. If you are at a beach, go to a nearby hill, tsunami evacuation building or higher building immediately.

● **Fire**
If you see a fire, please call 119. Cover your mouth and nose so that you won't inhale smoke and move away from the fire while making yourself as low as possible.

Useful Japanese phrases

| | English | Japanese | Romaji |
|-------------------|----------------------|------------|-------------------------|
| in town | Good morning | おはようございます | Ohayougozaimasu |
| | Hello | こんにちは | Konnichiwa |
| | Thank you | ありがとうございます | Arigatougozaimasu |
| | Delicious | おいしいです | Oishiidesu |
| | Good bye | さようなら | Sayounara |
| on transportation | How much? | いくらですか | Ikuradesuka |
| | Where I am? | ここはどこですか | Kokowa doko desuka |
| | I want to go~ | ~まで行きたいです | ~madeikitaidesu |
| on emergency | Help! | たすけて! | Tasukete! |
| | Take me to hospital! | 病院に連れて行って! | Byouin ni tsurete itte! |
| | Call the police! | 警察を呼んで! | Keisatsu wo yonde! |



By increasing international understanding through experiencing of different cultures, students of the same age with different national origins and cultures can enhance and foster their internationality. Exchange programs vary depending on schools and timing of participation, but it is guaranteed that every student can participate in a program where they can understand each other across a language barrier by taking classes and playing sports together, as well as by introducing their own music and traditional culture to each other.

Since Kanagawa Prefecture has attractive aspects of an urban area yet is surrounded by abundant nature of the ocean and mountains, many students are open and cheerful and looking forward to experiencing various types of exchange with you.

School Exchange Programs



Feedback from the students (Japan)

- As it was the first time for me to do a homestay, I was nervous. But I was able to communicate with people across the language barrier.
- It was a very good experience for me because we could know and understand each other well.
- I would like to apply this experience to the future.

I really appreciate how sincerely and kindly the school in Yokohama interacted with us. The students were communicating both in English and Japanese, successfully understanding each other's culture, which I really think was wonderful.

They welcomed us with a big party and I really felt the spirit of "omotenashi" of Japanese people. Their hospitality really sank deep into my heart.

I think that the students, even when words were inadequate, could realize the importance of understanding each other through non-verbal communication as well as communicating their own activities to other students.

Feedback from the teachers



(Taiwan)



(Japan)

Interview



You can feel and learn Japanese customs and culture intimately, which is an experience usually not accessible on an ordinary trip, by staying at someone's house or guest house to spend time with local people.

Having both urban environments and abundant natural scenery, Kanagawa Prefecture can uniquely offer various attractive experiences, as well as providing a safe and secure environment. It is highly recommended not only to join school exchange programs but also to make a lifetime memory through a stay in Kanagawa Prefecture, which is readily accessible from Tokyo and major airports.

Home Stay, etc.



1

Tourism Promotion Division, Industrial Promotion Department, Economic and Labor Affairs Bureau, Kawasaki City Kawasaki City Tourist Association
 ☎(C): +81(0)44-200-0509, (A): +81(0)44-544-8229
 ✉(C): 28kankou@city.kawasaki.jp, (A): kankou@k-kankou.jp
 🗣️ Language: English available (email only)

Kawasaki City is located between Tokyo and Yokohama, near Haneda Airport. Our tourism facilities and industrial facilities offer various experience-based activities.

2

"Yokosuka West Coast Tours" Promotion Council Executive Office (JTB Corporate Sales Inc.)
 ☎+81(0)46-824-4216
 ✉t_tanaka652@jtb.com
 🗣️ Language: Japanese only

With good access from Tokyo and abundant nature, the Yokosuka west coast area can offer you an opportunity not only to try your hand at farming and fishing but also to experience cordial communication with local people through everyday activities.

3

Institute for Language Experience, Experiment & Exchange (LEX), Hippo Family Club
 ☎+81(0)3-5467-7041
 ✉homestay-injp@lexhippo.gr.jp
 🗣️ Language: English/Chinese is available

We enjoy international exchanges in various languages. We welcome everyone from any country, individual or family, young or old, for a homestay with us.

4

Business Development Division, Economic Department, Miura City
 ☎+81(0)46-882-1111
 ✉keizai0601@city.miura.kanagawa.jp
 🗣️ Language: Japanese only

With mild weather, Miura City is blessed with fresh fish and vegetables. Enjoy interacting with a kind *okami-san* (landlady) at *minshuku* (small-scale ryokan).

5

Isehara Tourist Association
 ☎+81(0)463-73-7373
 ✉i-kanko@msa.biglobe.ne.jp
 🗣️ Language: English available

Isehara City has abundant nature and numerous historical remains. We offer a unique accommodation plan for staying at *shukubo* (temple lodging).

List of Facilities in Kanagawa Prefecture

- Industrial Tourism
- 1 TOKYO STRAWBERRY PARK
 - 2 Nissan Motor Co., Ltd. Yokohama Factory Guest Hall and Nissan Engine Museum
 - 3 Mitsubishi Minatomirai Industrial Museum
 - 4 Factory Night View Jungle Cruise (offered by Reserved Cruise)
 - 5 CUPNOODLES MUSEUM YOKOHAMA
 - 6 Shin-Yokohama Raumen Museum
 - 7 Ajinomoto Co., Inc. Kawasaki Factory
 - 8 Kureha Ecology Management, Kanagawa Office
 - 9 Toshiba Science Museum
 - 10 JAXA Sagamiara Campus
 - 11 Nissan Motor Co., Ltd. Oppama Plant Guest Hall
 - 12 A CRUISE OF YOKOSUKA NAVAL PORT
 - 13 Shonan Robo Care Center, INC.
 - 14 Yakult Honsha Co., Ltd. Shonan Cosmetics Plant
 - 15 Isuzu Plaza
 - 16 Suzuhiro Kamaboko Museum

- Mt. Fuji
- 17 Misaki Seafood Regional Wholesale Market
 - 18 Kanagawa Prefecture Disaster Management Center
 - 19 Megmilk Snow Brand Co., Ltd. Ebina Plant
 - 20 Kirin Beverage Co., Ltd. Shonan Plant
 - 21 me-byo XPLAZA
 - 22 Miyagase Dam

- History
- 23 Sail Training Ship NIPPON MARU/Yokohama Port Museum
 - 24 Sankeien Garden
 - 25 Kanagawa Prefectural Museum of Cultural History
 - 26 Nihon Minka-en (Japan Open-air Folk House Museum)
 - 27 Historical Residence (OBARAJUKU-HONJIN)
 - 28 World-Renowned Memorial Ship MIKASA
 - 29 Tsurugaoka Hachimangu Shrine
 - 30 Kotoku-in Temple with Kamakura Daibutsu (Great Buddha)
 - 31 Enoshima-jinja Shrine
 - 32 Odawara Castle
 - 33 Oyama Afuri-jinja Shrine
 - 34 Daiyuzan Saijo-ji Temple
 - 35 Samukawa-jinja Shrine
 - 36 Former Residence of YOSHIDA Shigeru
 - 37 Ashigarigo Setoyashiki
 - 38 Hakone Sekisho

- Yokohama Area
- Yokosuka/Miura Area
- Shonan Area
- Kawasaki Area
- Central Prefectural Area
- Western Prefectural Area

- Culture and Art
- 39 Soji-ji Head Monastery
 - 40 Yokohama City Craftspeople Assembly Hall
 - 41 aspen grove IDOGAYA
 - 42 TARO OKAMOTO MUSEUM OF ART, KAWASAKI
 - 43 Kawasaki City Fujiko-F•Fuji Museum
 - 44 Fujino workshop for art
 - 45 Kamakura Hase-dera Temple
 - 46 ICHIJU EKAN SANSO Important Cultural Property
 - 47 Public Interest Incorporated Foundation Kamakura Noh Theatre
 - 48 Kamakurabori Museum
 - 49 Takara-no-niwa (Kita-Kamakura)
 - 50 Enoden
 - 51 Fujisawa Ukiyo-e Museum (Fujisawa City)
 - 52 ODWARA-JUKU NARIWAI Rest House
 - 53 Mitomi Somemono-ten
 - 54 Soba Restaurant Shinonome
 - 55 Hatajuku Parquet Hall
 - 56 The Hakone Open-Air Museum
 - 57 Pola museum of art
 - 58 Narukawa Art Museum (lakeside of Lake Ashi in Hakone)
 - 59 Japanese Confectionery Mirakuan
 - 60 Living National Treasure Museum
 - 61 Kominka Yamajutei
- Nature
- 62 Orbi Yokohama
 - 63 Yokohama Hakkeijima Sea Paradise
 - 64 Yokohama Zoological Gardens ZOORASIA
 - 65 Ikuta Ryokuchi Rose Garden
 - 66 Sagamiiko Resort Pleasure Forest (Muscle Monster)
 - 67 The Life Museum of Azabu University
 - 68 Kannonzaki Nature Museum
 - 69 Nagai Seaside Park Soleil Hill
 - 70 Kanagawa Prefectural Center of Flowers and Greenery, Kana Garden
 - 71 Kanagawa Prefectural Museum of Natural History
 - 72 Koajiro-no-mori Forest
 - 73 Ninomiya Town Tourist Association (seine fishing)
 - 74 Ninomiya Town Tourist Association (Mandarin orange picking)
 - 75 HAKONE GEOMUSEUM
 - 76 Manazuru Umi-no-gakko (Endo Shell Museum)
 - 77 Manazuru Peninsula Tour Boat
 - 78 Hattori Dairy Farm
- Sport
- 79 Bank of Yokohama Ice Arena
 - 80 YOKOHAMA STADIUM
 - 81 Budo Karate (martial art and karate) Imai Dojo
 - 82 Nissan Stadium
 - 83 SNOVA MIZONOKUCHI-R246
 - 84 Sagami-hara Gion Stadium (Sagami-hara Asamizo Park Stadium)
 - 85 Shonan Bellmare Hiratsuka Beach Park by shonanzoen
 - 86 Forest Adventure Odawara/Hakone
 - 87 Miura Umikaze Bike Rental

Industrial Tourism

Required Time for Experience / Tour

Chinese English Multilingual support availability on telephone inquiry

Telephone number Open hours Closed

Address Access

Maximum capacity (persons) Admission

Necessity of interpretation

Necessity of reservation How to make a reservation Reservation deadline

Parking

1.TOKYO STRAWBERRY PARK

Yokohama



Strawberries are a magical fruit that can make anyone smile (anyone who bites smile). This strawberry-themed park is full of various attractive aspects of strawberries that make people happy.

+81(0)45-394-5555 Weekdays 11:00~16:00 Weekends/Holidays 10:00~18:00 Wed 11-1 Daikoku-cho, Tsurumi-ku, Yokohama City 15 min by bus from Tsurumi Sta on JR, Keiikyuu lines Please ask the staff 1,500~2,980 yen Required * strawberry picking Required (Web) Until 4 p.m. on the day prior to visit Available

6.Shin-Yokohama Raumen Museum

Yokohama



You can enjoy various kinds of ramen not only from Japan but also from other countries. At the popular gallery, you can learn about the culture and history of ramen.

+81(0)45-471-0503 11:00~21:30 New year holidays 2-14-21 Shin-yokohama, Kohoku-ku, Yokohama City 5 min walk from Shin-Yokohama Sta on JR Line 100~310 yen Not required (—) Not available

7.Ajinomoto Co., Inc. Kawasaki Factory

Kawasaki



Ajinomoto Co., Inc. Kawasaki Factory offers three hands-on factory tours, including "Ajinomoto®" course, "Hondashi®" course, and "Cook Do®" course, in which you can enjoy learning about the products.

— 9:30~16:00 Sun and other days 3-4 Suzuki-cho, Kawasaki-ku, Kawasaki City 1 min walk from Suzukicho Sta. on Keiikyuu Line Please ask the staff Free Required Required (10 people and less: Web 11 people and over: Phone) 24 days prior to visit for 10 people and under, 7 days prior to visit for 11 people and over *URL: https://www.ajinomoto.co.jp/kfb/kengaku/kawasaki/ Available

2.Nissan Motor Co., Ltd. Yokohama Factory Guest Hall and Nissan Engine Museum

Yokohama



Since starting its operation in 1935, this factory has been conducting integrated manufacturing of engines and suspensions. You can see the engine assembly lines as well as past models of engines.

+81(0)45-461-7090 9:00~17:00 Sun and other days *On Sat only the museum is available 2 Takara-cho, Kanagawa-ku, Yokohama City 20 min walk from Shinkoyasu Sta. on JR, Keiikyuu lines 2~60 people Free Required Required (Phone, Web) 3 months - 1 day prior to visit Available

3.Mitsubishi Minatomirai Industrial Museum

Yokohama



This facility offers an opportunity for fun learning about cutting-edge science technologies, such as aerospace science and environmental energy, through simulators and other hands-on exhibitions as well as real items used in the field.

+81(0)45-200-7351 10:00~17:00 (admission until 16:30) Tue and other days 3-3-1 Minatomirai, Nishi-ku, Yokohama City 3 min walk from Minatomirai Sta on Minatomirai Line 200 people 200~500 yen Please ask the staff Required (Web) 3 days prior to visit Available

8.Kureha Ecology Management, Kanagawa Office

Kawasaki



Wastech Kanagawa is a processing facility for industrial waste. This facility offers a tour to watch the selection and shredding process of waste material as well as the operation of the incinerators.

+81(0)44-280-3810 9:00~16:30 Sat, Sun and other days 6-1 Chidori-cho, Kawasaki-ku, Kawasaki City 25 min by bus from Kawasaki Sta on JR Line 50 people Free Required Required (Phone, Email: kengaku@kurekan.co.jp) 2 weeks prior to visit Please ask the staff

9.Toshiba Science Museum

Kawasaki



Science and technology from past to present is nicely shown at this museum. You can join demonstrations of 500,000 volts of static electricity, superconductivity, and others.

+81(0)44-549-2200 Weekdays 10:00~17:30 Weekends/Holidays 10:00~18:00 Mon and other days 72-34 Horikawa-cho, Saiwai-ku, Kawasaki City 1 min walk from Kawasaki Sta on JR Line Please ask the staff Free Not required (required for language other than Japanese, English, Chinese) Required (Phone, Web) Please ask the staff Available

4.Factory Night View Jungle Cruise (offered by Reserved Cruise)

Yokohama



Look at the night view of Japan's largest Keihin Industrial District from the canal and enjoy beautiful illumination of numerous plants, storage tanks and storehouses, and other buildings that are lined sloths canal.

+81(0)45-290-8377 10:00~18:00 Mon~Thur 1-1 Shinko, Naka-ku, Yokohama City 10 min walk from Bashamichi Sta on Minatomirai Line 50 people 2,300~4,600yen Required *Charter service is available. Required (Phone, Web, Email) 1 week prior to visit Available

5.CUPNOODLES MUSEUM YOKOHAMA

Yokohama



At this hands-on dietary education museum, you can learn how important and fun invention and discovery are through various experiences and exhibitions related to instant ramen noodles and their history.

+81(0)45-345-0918 10:00~18:00 (admission until 17:00) Tue and other days 2-3-4 Shinko, Naka-ku, Yokohama City 8 min walk from Minatomirai Sta, Bashamichi Sta on Minatomirai Line Please ask the staff Admission Adult: 500 yen, Senior high school students and under: free, workshop: 300~500 yen * Required time for workshop varies according to the course Not required Required (Chicken Ramen Factory) (Phone: +81(0)45-345-0825, Web) 3 months - 1 day prior to visit Not available

10.JAXA Sagami-hara Campus

Central Prefectural



You can freely explore the models of various probe vehicles and rockets. There is also a real rocket outside.

+81(0)42-759-8008 10:00~17:30 (admission until 17:15) Mon and other days 3-1-1 Yoshinodai, Chuo-ku, Sagami-hara City 20 min walk from Fuchinobe Sta on JR Line Please ask the staff Free required Not required (—) Not available

11.Nissan Motor Co., Ltd. Oppama Plant Guest Hall

Yokosuka /Miura



One of the most advanced automated passenger vehicle assembly plants is equipped with welding robots as well as lines that allow the simultaneous production of different kinds of vehicles. Currently, it conducts simultaneous production of electric cars and gas vehicles.

+81(0)46-867-5013 9:00~17:00 Sat, Sun and other days 1 Natsushima-cho, Yokosuka City 20 min walk from Oppama Sta on Keiikyuu Line 2~60 people Free Required Required (Phone, Web) 3 months - 1 day prior to visit Available

12.A CRUISE OF YOKOSUKA NAVAL PORT

Yokosuka
/Miura



This is the only cruise tour in Japan that offers an opportunity to see US naval vessels and Japan Maritime Self-Defense Force warships up close.

☎+81(0)46-825-7144 ☎11:00~15:00 ☎Open 365 days (may be closed due to weather)
📍2-12 Hon-machi, Yokosuka City 📍5 min walk from Shioiri Sta on Keikyū Line 📍50 people
📞700~1,400 yen 📞Required
📞Required (Reservation available through Japanese travel agencies)
📞Please ask the staff

Available

14.Yakult Honsha Co., Ltd. Shonan Cosmetics Plant

Shonan



The plant offers a factory tour for adults, in which you can “feel” original components of products using your five senses.

☎+81(0)466-25-8960 ☎9:00~17:00 ☎Sat, Sun, holidays and other days 📍2-5-10 Kugenumashinmei, Fujisawa City 📍10 min by bus from Fujisawa Sta on JR, Odakyu, Enoden lines
📍35 people 📞Free 📞Required
📞Required (Phone) 📞1 week prior to visit

Available

16.Suzuhiro Kamaboko Museum

Western
Prefectural



Have fun and learn about the history, mystery, ingredients, and nutrition of *kamaboko* (steamed seasoned fish paste) at this museum. You can watch kamaboko makers using their techniques through the glass and join a real kamaboko making class (reservation required).

☎+81(0)465-24-6262 ☎9:00~17:00 ☎New year holidays and other days 📍245 Kazamatsuri, Odawara City 📍1 min walk from Kazamatsuri Sta on Hakone Tozan Railway Line
📍24~40 people (varies according to the course) 📍1,000~1,500 yen 📞Not required
*Required Time for Experience (varies according to the course)
📞Required (Phone, Web) 📞The day before visit

Available

13.Shonan Robo Care Center, INC.

Shonan



This is one of the biggest such centers in Japan, where cutting-edge training using a robot suit HAL® is offered.

☎+81(0)466-30-2360 ☎10:00~17:00 ☎Mon, Sun, holidays and other days 📍2-2-1 Tsujidokandai, Fujisawa City 📍4 min walk from Tsujido Sta on JR Line
📍40 people 📞2,700yen *in case of less than 10 people, total charge is 27,000 yen 📞Required
📞Required (Phone, Email: contact_shn@rc.cyberdyne.jp)
📞Please ask the staff

Available

15.Isuzu Plaza

Shonan



This facility offers a place where you can enjoy learning about the history of Isuzu automobiles, which have been supporting “transportation,” precious restored Isuzu cars, the latest trucks and buses, and development and manufacturing technologies, through the experience-based exhibition.

☎+81(0)466-41-5811 ☎10:00~17:00(admission until 16:00) ☎Mon, Sun and other days
📍8 Tsuchidana, Fujisawa City 📍10 min by free shuttle bus from Shonandai Sta on Odakyu, Soetsu, Yokohama Municipal Subway lines
📍320 people 📞Free 📞Required
📞Required (Web, you can see freely on Sat and holidays)
📞2 days prior to visit

Available

17.Misaki Seafood Regional Wholesale Market

Yokosuka
/Miura



You can watch how fish, such as huge frozen tuna, mackerel, and splendid alfonso, are traded inside Misaki Fish market, from the tour passage on the 2nd floor.

☎+81(0)46-882-1111 ☎8:00~10:00 ☎No fixed holidays 📍5-245-7 Misaki, Miura City
📍15 min by bus from Misakiguchi Sta on Keikyū Line 📞Please ask the staff
📞Free 📞Required *At the time of reservation, please send the fax to two facilities below.
📞Required (Phone, FAX: +81(0)46-881-6667, +81(0)46-888-5914)
📞1 month prior to visit

Available

18.Kanagawa Prefecture Disaster Management Center

Central
Prefectural

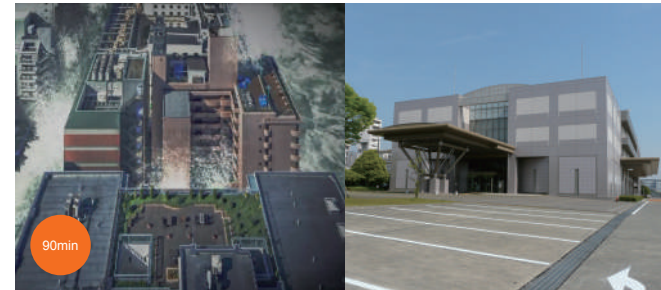

You can experience various “disasters”, including wind and water, as well as learn useful information about disasters at various disaster information displays.

☎+81(0)46-227-1700 ☎9:00~17:00(admission until 16:30) ☎Mon and other days
📍280 Shimotsukoku, Atsugi City 📍6 min by bus from Aikoishida Sta on Odakyu Line
📍150 people 📞Free 📞Required
📞Required (for 10 people and over) (Phone) 📞The day before visit

Available

20.Kirin Beverage Co., Ltd. Shonan Plant

Shonan



This plant offers a factory tour where you can “see” and “touch” to learn the secret of the deliciousness of “Kirin Gogo-no-kocha” tea.

☎+81(0)467-30-9000 ☎Tour (1) from 10:30 (2) from 14:30 ☎Mon and other days
📍1620 Kurami, Samukawa-machi, Koza County 📍15 min walk from Kurami Sta on JR Line
📍30 people 📞Free 📞Required
📞Required (Phone, Web) 📞2 days prior to visit

Available

22.Miyagase Dam

Central
Prefectural



One of the biggest dams in the metropolitan area. One of the highlights of this dam is the overwhelming water discharge at scheduled times.

☎+81(0)46-281-6911 ☎9:00~17:15 ☎Dec 29~Jan 3 📍5423 Saki Hanbara, Aikawa-machi, Aiko County
📍60 min by bus from Honatsugi Sta on Odakyu Line 📍No limit
📞Free 📞Not required
📞Not required (—) 📞—

Available

19.Megmilk Snow Brand Co., Ltd. Ebina Plant

Central
Prefectural



One of Japan's largest market milk plants offers a tour in which you can watch the production process of beverages in paper packs and plastic bottles, including milk, fruit juice drinks, and yogurt drinks, via the designated tour course.

☎+81(0)46-240-6300 ☎Factory Tour (1) From 10:00 (2) From 13:30 ☎Fri, Sun and other days
📍5-26-1 Nakashinden, Ebina City 📍15 min walk from Atsugi Sta on JR, Odakyu lines
📍20 people 📞Free 📞Required
📞Required (for 10 and more people) (Phone) 📞2 months - 7 days prior to visit

Available

21.me-byo XPLAZA

Western
Prefectural



This experience-based facility will motivate you to learn about *me-byo* (the state before getting an illness) and review your lifestyle in a fun way. Enjoy the hands-on activities and think about me-byo!

☎+81(0)465-46-6087 ☎10:00~17:00 ☎Mon and other days 📍300 Yamada, Oi-machi, Ashigarakami County
📍10 min by bus from Shinmatsuda Sta on Odakyu Line 📍50 people
📞Free 📞Required
📞Required (for 20 people and over)(Phone) 📞The day before visit

Available



History



Required Time for Experience / Tour

Chinese English Multilingual support availability on telephone inquiry

☎Telephone number 🕒Open hours 🚫Closed

📍Address 📍Access

👤Maximum capacity (persons) 🎫Admission

🗣️Necessity of interpretation

📅Necessity of reservation 📅How to make a reservation 📅Reservation deadline

P Parking

23.Sail Training Ship NIPPON MARU/ Yokohama Port Museum

Yokohama



Nippon Maru Memorial Park in the Minato Mirai 21 district is home to the Sail Training Ship NIPPON MARU and Yokohama Port Museum. You can go into and look around the ship, which is a government-designated important cultural property, and try the ship handling simulator at the museum.

☎+81(0)45-221-0280 🕒10:00~17:00 (admission until 16:30) 🗓️Mon and other days 📍2-1-1 Minatomirai, Nishi-ku, Yokohama City 📍5 min walk from Sakuragicho Sta on JR, Yokohama Municipal Subway lines 🗣️Please ask the staff 💰200~500 yen

🗣️Required 📞Required (Phone) 📅—

P Available

28.World-Renowned Memorial Ship MIKASA

Yokosuka /Miura



As the oldest steel-hulled battleship in the world, this ship is a place where you can feel and learn about the history of modernization in Japan after the Meiji Restoration of 1868.

☎+81(0)46-822-5225 🕒Apr~Sep 9:00~17:30 Mar, Oct 9:00~17:00 Nov~Feb 9:00~16:30 🗓️Dec. 28-31 📍82-19 Inaoka-cho, Yokosuka City 📍15 min walk from Yokosukachyuo Sta on Keikyu Line 📍300名 📍300~600 yen 🗣️Please ask the staff

🗣️Required (for 10 people and over) (Web) 📅The visit day

P Available

29.Tsurugaoka Hachimangu Shrine

Yokosuka /Miura



One of the most famous historic sites in Kamakura. If you look at the shrine buildings from Wakamiya Oji Street, which stretches to the beach, the brilliant red color of the lacquer coating of the buildings, the green color of the mountains, and the blue color of the sky create a wonderful contrast.

☎+81(0)467-22-0315 🕒6:00~20:30 🗓️Open 365 days 📍2-1-31 Yukinoshita, Kamakura City 📍10 min walk from Kamakura Sta on JR, Enoden lines 📍— 🗣️Homotsuden Hall (treasure hall): 100~200 yen 🗣️Please ask the staff

📅Not required (—) 📅—

P Available

24.Sankeien Garden

Yokohama



With 17 historical buildings that were transferred from other places, such as Kyoto and Kamakura, this Japanese garden shows the beautiful harmony between the buildings and seasonal nature. You can join a hands-on experience of a tea ceremony.

☎+81(0)45-621-0635 🕒9:00~17:00 (admission until 16:30) 🗓️Dec 29-31 📍58-1 Honmokusannotani, Naka-ku, Yokohama City 📍10 min by bus from Negishi Sta on JR Line

📍Tea ceremony workshop: 24 seats available 🎫Admission: 200~700 yen, Tea ceremony workshop (with sweets): 500 yen 🗣️Not Required

📅Required(Phone) 📅The visit day

P Available

25.Kanagawa Prefectural Museum of Cultural History

Yokohama

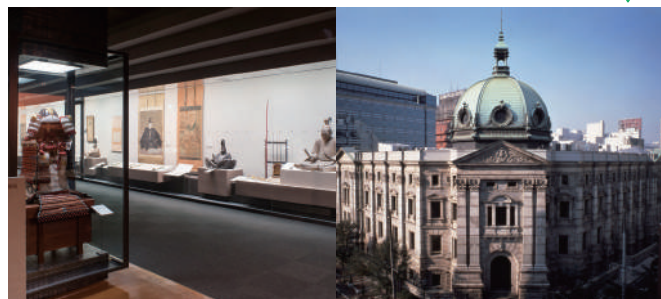

This museum introduces the culture and history of Kanagawa Prefecture. The old building part has been designated as a national important cultural property.

☎+81(0)45-201-0926 🕒9:30~17:00 (admission until 16:30) 🗓️Mon and other days 📍6-60 Minaminakadori, Naka-ku, Yokohama City 📍1 min walk from Bashamichi Sta on Minatomirai Line 🗣️Please ask the staff 💰100~300 yen, for special exhibition additional charge is required

🗣️Required 📞Required (Phone) 📅2 weeks prior to visit

P Please ask the staff

30.Kotoku-in Temple with Kamakura Daibutsu (Great Buddha)

Yokosuka /Miura



The statue commonly known as Kamakura Daibutsu (Great Buddha of Kamakura), a colossal bronze image of Amida-butsu (Amitabha Buddha), is the principle image of Kotoku-in temple. Its construction started in 1252.

☎+81(0)467-22-0703 🕒Apr~Sep 8:00~17:30 Oct~Mar 8:00~17:00 (admission until 15 min before closing) 🗓️Open 365 days 📍4-2-28 Hase, Kamakura City 📍7 min walk from Hase Sta on Enoden Line 📍— 💰150~200 yen 🗣️Not required

📅Not required (—) 📅—



P Not available

31.Enoshima-jinja Shrine

Shonan



Since ancient times, this shrine has been worshipped as a place enshrining the goddess Benzaiten. It is said to bring good luck in show business, economic fortune, and marriage ties.

☎+81(0)466-22-4020 🕒8:30~17:00 🗓️Open 365 days 📍2-3-8 Enoshima, Fujisawa City 📍15 min walk from Katase-Enoshima Sta on Odakyu Line 📍— 🗣️Hoanden Hall (Bentendo): 150~200 yen 🗣️Required

📅Not required (—) 📅—

P Not available

26.Nihon Minka-en (Japan Open-air Folk House Museum)

Kawasaki



This open-air museum contains 25 buildings that have been designated as cultural properties. Standing in grounds rich in nature, this museum offers various events as well as casual hands-on experience sessions, such as indigo dyeing.

☎+81(0)44-922-2181 🕒Mar~Oct 9:30~17:00 Nov~Feb 9:30~16:30 🗓️Mon and other days 📍7-1-1 Masugata, Tama-ku, Kawasaki City 📍13 min walk from Mukogaokayuen Sta on Odakyu Line

📍Entry to the house: No particular limitation indigo dyeing workshop: about 25 people (For details please ask the staff) 💰500 yen, workshop 620 yen~ 🗣️Required (audio translation can be used) *English tour guide for groups available (application 2 weeks in advance is required).

📅Required (Phone, Email) 📅The day before visit

P Available

27.Historical Residence (OBARAJUKU-HONJIN)

Central Prefectural



This is the only existing building used as a *honjin* (an inn for government officials in the Edo period) out of 26 that once existed in Kanagawa Prefecture. It has been designated as an important cultural property by the prefecture as well as a structure of landscape importance by Sagami-hara City.

☎+81(0)42-684-4780 🕒9:30~16:00 (admission until 15:30) 🗓️Mon and other days 📍698-1 Obara, Midori-ku, Sagami-hara City 📍5 min by bus from Sagamiko Sta on JR Line

📍50 people 📍Free 🗣️Required

📅Required (Phone) 📅—

P Available

32.Odawara Castle

Western Prefectural



At this castle, you can learn about the history of the Sengoku period (Age of Warring States). At the Togiwagi-mon gate, there is a rental service for a suit of armor and other costumes of that period.

☎+81(0)465-23-1373 🕒Castle Park: Open 24 hours Fee-charging facility open hours 9:00~17:00 (admission until 16:30) *Open hours can be longer 🗓️Dec 31~Jan 1 and other days 📍Jyonai, Odawara City 📍10 min walk from Odawara Sta on JR, Odakyu, Hakone Tozan Railway, Izu Hakone Railway lines 🗣️Please ask the staff 📍Castle Park: Free, additional fee for other facilities 🗣️Required (guidance app for smartphone in English and Chinese can be used) 📅Required (Phone) 📅Please ask the staff

P Available

33.Oyama Afuri-jinja Shrine

Shonan



In the Edo period, about 200,000 people visited this old shrine every year. There remain many traditions and old customs at this shrine, where you can request a formal rite of prayer as well as join a *nogaku* (Noh drama) hands-on session.

☎+81(0)463-95-2006 🕒Same as the cable car operation hours 🗓️Open 365 days 📍355 Oyama, Isehara City 📍25 min by bus from Isehara Sta on Odakyu Line, ride the Oyama cable car to the last station. 📍50 people 📍Free visit: no charges, formal visit: 5,000 yen and over 🗣️Required

📅Required (Phone) 📅Please ask the staff

P Available

34.Daiyuzan Saijo-ji Temple



Belonging to the Soto school of Buddhism, this temple has more than 4,000 branch temples all over Japan. It is also famous as the temple of tengu (long-nosed goblin).

☎ +81(0)465-74-3121 ☎ 6:00~16:00 ☎ Open 365 days 📍 1157 Daiyuchu, Minamishigara City 🚶 10 min by bus from Daiyuzan Sta on Izu Hakone Railway lines 🧑 36 people 💰 10,000 yen (up to 20 people), 500 yen per person for more than 20 people 📄 Required *Please ask the staff for reservation and application for zazen experience. 📞 Required (Phone) 📅 1 month prior to visit 🅐 Available (Please ask the staff)

35.Samukawa-jinja Shrine



Also called Sagamino-kuni Ichinomiya, this shrine has about 1,600 years of history enshrining the guardian god of *happo yoke*, the divine power to expel evil and ward off disasters.

☎ +81(0)467-75-0004 ☎ 8:00~17:00 (gate open 6:00~sunset) ☎ Open 365 days 📍 3916 Miyayama, Samukawa-machi, Koza County 🚶 5 min walk from Miyayama Sta on JR Line 🚶 - ☎ Free 📄 Please ask the staff 📞 Not required (—) 📅 - 🅐 Available

36.Former Residence of YOSHIDA Shigeru



This building was used as a private residence of Yoshida Shigeru (1878-1967), who was prime minister during the postwar reconstruction period. With Yoshida Shigeru as the main theme, this facility exhibits materials related to modern Japanese history.

☎ +81(0)463-61-4777 ☎ 9:00~16:30 (admission until 16:00) ☎ Mon, 1st of every month and other days 📍 418 Nishikoiso, Oiso-machi, Naka County 🚶 5 min by bus from Oiso Sta on JR Line 🚶 - 💰 150~500 yen 📄 Required 📞 Required (Phone: +81(0)463-61-0355 (Kanagawa Prefectural Oiso Joyama Park Office)) 📅 - 🅐 Available

37.Ashigarigo Setoyashiki



Setoyashiki is the mansion of the Seto Family, who were village headmen of the area in the Edo period. You can feel the tranquil atmosphere nurtured by over 300 years.

☎ +81(0)465-84-0050 ☎ 10:00~17:00 ☎ Mon and other days 📍 1336 Kanaishima, Kaisei-machi, Ashigarakami County 🚶 5 min by bus from Shin-Matsuda Sta on Odakyu Line 🚶 - ☎ Please ask the staff 📄 Required 📞 Required (Phone) 📅 - 🅐 Not available

38.Hakone Sekisho



This checkpoint is said to had been installed at the current location in 1619. Based on the historical materials of that time and results from excavation, the buildings were fully recreated in the original arrangement, shapes, and colors in 2007.

☎ +81(0)460-83-6635 ☎ Mar~Nov 9:00~17:00 Dec~Feb 9:00~16:30 (admission until 30 min before closing) ☎ Open 365 days 📍 1 Hakone, Hakone-machi, Ashigarashimo County 🚶 40 min by bus from Hakone Yumoto Sta on Hakone Tozan Railway Line 🚶 - 💰 250~500 yen 📄 - 📞 Not required (—) 📅 - 🅐 Not available



Culture and Art

Required Time for Experience /tour

Chinese English Multilingual support availability on telephone inquiry

☎ Telephone number ☎ Open hours ☎ Closed

📍 Address 📍 Access

👤 Maximum capacity (persons) ☎ Admission

📄 Necessity of interpretation

📄 Necessity of reservation 📄 How to make a reservation 📄 Reservation deadline

🅐 Parking

40.Yokohama City Craftspeople Assembly Hall



This facility has a permanent exhibition at "Takumi Plaza" of tools related to food, clothing, and housing that were actually used by craftsmen in the past, along with skills experience classes held irregularly.

☎ +81(0)45-681-6551 ☎ 9:00~22:00 (admission until 19:00) ☎ The second Wed of every month, Dec 29~Jan 3 📍 2-4-7 Bandai-cho, Naka-ku, Yokohama City 🚶 5 min walk from Kannai Sta on JR Line 📄 Please ask the staff ☎ Please ask the staff 📄 Required 📞 Required (Phone: +81(0)45-671-4098 (Yokohama Municipal Economic Affairs Employment Labor Division) Email: ke-ginou@city.yokohama.jp) 📄 Please ask the staff 🅐 Not available

42.TARO OKAMOTO MUSEUM OF ART, KAWASAKI



This museum exhibits works and materials donated by Taro Okamoto, the world-famous artist who was born in Kawasaki, as well as modern and contemporary art works.

☎ +81(0)44-900-9898 ☎ 9:30~17:00 (admission until 16:30) ☎ Mon and other days 📍 7-1-5 Masugata, Tama-ku, Kawasaki City 🚶 17 min walk from Mukogaokayuen Sta on Odakyu Line 📄 Please ask the staff ☎ Varies according to the exhibition 📄 Required 📞 Not required (—) 📅 - 🅐 Available

39.Soji-ji Head Monastery



This head monastery of Soto Zen Buddhism has 700 years of history. Available **zazen** practice includes various sessions (1hr~1.5hr) with or without reservation as well as English zazen sessions (once a month on a designated Saturday).

☎ +81(0)45-581-6021 ☎ 10:00~15:00 ☎ No fixed holidays 📍 2-1-1 Tsurumi, Tsurumi-ku, Yokohama City 🚶 7 min walk from Tsurumi Sta on Keikyu Line 🧑 50 people ☎ Please ask the staff 📄 Please ask the staff 📞 Required (Phone) 📅 3 days prior to visit 🅐 Available

41.aspen grove IDOGAYA



Specialized in wooden toy production using the yosegi (parquetry) of Hakone and Odawara. Through the woodworking experience, you can learn about parquetry and Japan's traditional toys.

☎ +81(0)80-3485-7394 ☎ 9:00~18:00 ☎ No fixed holidays 📍 154 Idogayanaka-machi, Minami-ku, Yokohama City 🚶 3 min walk from Idogaya Sta on Keikyu Line 🧑 12 people 💰 Workshop: 2,000 yen 📄 Not required 📞 Required (Web, Email) 📅 1 week prior to visit 🅐 Not available

43.Kawasaki City Fujiko•F•Fujio Museum



This cultural facility aims to introduce the world of the legendary manga artist, Fujiko F Fujio, and spread his messages to different generations through the exhibition of original drawings and other materials.

☎ - ☎ 10:00~18:00 ☎ Tue and other days 📍 2-8-1 Nagao, Tama-ku, Kawasaki City 🚶 10 min by shuttle bus from Noborito Sta on JR, Odakyu lines 🧑 2,000 people 💰 500~1,000 yen 📄 Not required 📞 Required (Lawson Ticket (convenience store)) 📅 The day before visit 🅐 Not available

44. Fujino workshop for art

Central
Prefectural



This place offers hands-on experience sessions of pottery, woodworking, and glassmaking, as well as a music hall and studio where you can practice music.

☎+81(0)42-689-3030 ☎9:00~21:00 Workshop 9:00~17:00 ☎Tue and other days ☎4819 Magino, Midori-ku, Sagami-hara City ♡5 min by bus from Fujino Sta on JR Line ☎Workshop: 60 people Stay: 100 people ☎Workshop: 1,000 yen~, for hotel charges ask the staff ☎Required ☎Required (Phone) ☎Please ask the staff

P Available

45. Kamakura Hase-dera Temple

Yokosuka
/Miura



The enshrined main image, an eleven-faced Kannon statue, is one of Japan's largest wooden Buddha statues. The grounds are always decorated with seasonal flowering trees and shrubs. A sutra copying session is offered every day.

☎+81(0)467-22-6300 ☎Mar-Sep 8:00~17:00 Oct-Feb 8:00~16:30 Shakyō (sutra copying) 9:00~15:00 ☎Open 365 days ☎3-11-2 Hase, Kamakura City ♡5 min walk from Hase Sta on Enoden Line ☎25 people ☎Visit: 100~300 yen, Sutra copying: 1,000 yen ☎Required ☎Required (FAX (Sutra copying)) ☎Please ask the staff

P Available

50. Enoden

Shonan



Connecting Fujisawa Station and Kamakura Station, this train line can offer a great view with both Enoshima and Mount Fuji visible on a clear day.

☎+81(0)466-24-2713 ☎From the first to the last train ☎Open 365 days ☎1-8-16 Kanasekaigan, Fujisawa City ♡5 min walk from Hase Sta on Enoden Line ☎25 people ☎Visit: 100~300 yen, Sutra copying: 1,000 yen ☎Required ☎Required (FAX (Sutra copying)) ☎Please ask the staff



P Not available

51. Fujisawa Ukiyo-e Museum (Fujisawa City)

Central
Prefectural



This facility showcases the collection of *ukiyo-e* owned by Fujisawa City, including those of Enoshima and the 53 Stations of the Tokaido Road, along with materials related to local history. An ukiyo-e hands-on session ("ukiyo-e suri taiken") is offered on the opening weekends.

☎+81(0)466-33-0111 ☎10:00~19:00 (admission until 18:30) ☎Mon and other days ☎2-2-2 Tsujidoukanai, Fujisawa City ♡5 min walk from Tsujido Sta on JR Line ☎50 people ☎Free ☎Required ☎Not required (—) ☎Please ask the staff

P Not available

46. ICHIJŌ EKAN SANŌ Important Cultural Property

Yokosuka
/Miura



This lodge was built by Ichijō Ekan, the 9th son of Emperor Go-Yōzei, the 107th Emperor of Japan in the Edo period. Enjoy the beautiful gardens as well as a tour inside the lodge and a tea-ceremony experience in the tea room.

☎+81(0)467-53-7900 ☎10:00~16:00 ☎Mon, Tue and other days ☎5-1-10 Jomyoji, Kamakura City ♡10 min by bus from Kamakura Sta on JR, Enoden lines ☎60 people ☎Admission: 500 yen, Workshop: Please ask the staff ☎Required ☎Required (Phone, Email) ☎1 month prior to visit

P Please ask the staff

47. Public Interest Incorporated Foundation Kamakura Noh Theatre

Yokosuka
/Miura



Founded with the purpose of promoting and spreading Japan's traditional "Noh" culture (nogaku) (listed on UNESCO's intangible cultural heritage list), this facility offers various Noh-related events, including nogaku performances and nogaku appreciation classes. It also has a Noh mini museum.

☎+81(0)467-22-5557 ☎10:00~16:30 ☎No fixed holidays ☎3-5-13 Hase, Kamakura City ♡7 min walk from Hase Sta on Enoden Line ☎155 people ☎300~500 yen ☎Required ☎Required (Phone, Web, Email) ☎The visit day

P Not available

52. ODAWARA-JUKU NARIWAI Rest House

Western
Prefectural



This facility offers a hands-on session to make your own Odawara chochin (Japanese paper lantern), one of the traditional crafts of Odawara.

☎+81(0)465-20-0515 ☎Apr-Oct 10:00~19:00 Nov-Mar 10:00~18:00 ☎Dec 31 ☎3-6-23 Honcho, Odawara City ♡14 min walk from Odawara Sta on JR, Odakyu, Hakone Tozan Railway, Izu Hakone Railway lines ☎35~40 people ☎Japanese lantern making workshop: 1,000 yen ☎Required ☎Please ask the staff (Phone: +81(0)465-22-5002 (Odawara City Tourism Association)) ☎2 weeks prior to visit

P Not available

53. Mitomi Somemono-ten

Yokosuka
/Miura



Starting business in 1833, this dye shop served as a purveyor of the Tokugawa Shogunate. It is still dyeing manually using traditional techniques. If you are interested, you can make your own taiyō-bata, a traditional fisherman's flag to indicate a large catch of fish.

☎+81(0)46-881-2791 ☎8:00~20:00 ☎No fixed holidays ☎1-10-9 Misaki, Miura City ♡15 min by bus from Misakiguchi Sta on Keiyou Line ☎Please ask the staff ☎3,500 yen ☎Required ☎Required (Phone, Email) ☎2 days prior to visit

P Not available

48. Kamakurabori Museum

Yokosuka
/Miura



This museum exhibits Kamakurabori works and related materials and offers regular sessions to show videos of the production processes. Popular hands-on carving sessions are frequently offered.

☎+81(0)467-25-1502 ☎9:30~17:00 (admission until 16:30) ☎Mon and other days ☎2-15-13 Komachi, Kamakura City ♡5 min walk from Kamakura Sta on JR, Enoden lines ☎100 people ☎Admission: 150~300 yen, Workshop: 1,300~3,200 yen ☎Required ☎Required (Workshop: Web Observation: Phone, Email) ☎1 week prior to visit

P Not available

49. Takara-no-niwa (Kita-Kamakura)

Yokosuka
/Miura



This *kominka* (old folk house) atelier in Kitakamakura offers Japanese cultural experience classes, such as *wagashi* (Japanese sweets) making, pottery, tea ceremony, *kodo* (incense), Japanese painting, and *shojin* (vegetarian Buddhist cuisine) cooking.

☎+81(0)80-6866-9018 ☎10:00~16:00 ☎No fixed holidays ☎1418 Yamanouchi, Kamakura City ♡10 min walk from Kita-Kamakura Sta on JR Line ☎40 people ☎2,000 yen~ ☎Required ☎Required (Email: takaranoniwa@gmail.com) ☎1 month prior to visit

P Not available

54. Soba Restaurant Shinonome

Shonan



Located inside the Furusato Densho-kan building at Tawara Fukusato Park, this soba place offers a soba-making class, in which you can enjoy making and eating soba noodles.

☎+81(0)463-84-1282 ☎11:00~15:30 ☎Mon and other days ☎999 Higashitawara, Hadano City ♡20 min by bus from Hadano Sta on Odakyu Line ☎50 people ☎1,400 yen ☎Required ☎Required (Phone) ☎1 month prior to visit

P Please ask the staff

55. Hatajuku Parquet Hall

Western
Prefectural



This facility exhibits and sells Hakone parquet crafts. You can join a parquet coaster making class as well as observe the actual production process by craftsmen.

☎+81(0)460-85-8170 ☎9:30~16:30 ☎Open 365 days ☎103 Hatajuku, Hakone-machi, Ashigarashimo County ♡20 min by bus from Hakone Yumoto Sta on Hakone Tozan Railway Line ☎70 people ☎800 yen ☎Required ☎Required (Phone) ☎3-1 month prior to visit

P Available

56.The Hakone Open-Air Museum



Known as Japan's first outdoor art museum, this museum exhibits as many as 120 art works by masters from Japan and other countries on the huge grounds. There are also five indoor exhibition halls, including Picasso Pavilion, as well as an onsen foot bath facility.

☎+81(0)460-82-1161 ☎9:00~17:00(admission until 16:30) ☎Open 365 days 📍1121 Ninotaira, Hakone-machi, Ashigarashimo County 📍2 min walk from Chokokunomori Sta on Hakone Tozan Railway Line 📍— 📍800~1,600 yen 📍Required 📍Required (Phone) 📍—



57.Pola museum of art



This museum has a wide-ranging collection from European paintings, including those by Monet, Renoir, and Picasso, and Japanese art works including paintings, glass craft, and oriental ceramics.

☎+81(0)460-84-2111 ☎9:00~17:00 ☎Open 365 days (closed during exhibition change) 📍1285 Kozukayama, Sengokuhara, Hakone-machi, Ashigarashimo County 📍13 min by bus from Gora Sta on Hakone Tozan Railway Line 📍— 📍700~1,800 yen 📍Not required 📍Not required (—) 📍—



58.Narukawa Art Museum (lakeside of Lake Ashi in Hakone)



Opened in April 1988, this art museum exhibits modern Japanese-style paintings. Its collection of Japanese paintings includes more than 4,000 pieces. This museum is also famous for its great panoramic view of Lake Ashi and Mount Fuji.

☎+81(0)460-83-6828 ☎9:00~17:00 ☎Open 365 days 📍570 Motohakone, Hakone-machi, Ashigarashimo County 📍35 min by bus from Hakone Yumoto Sta on Hakone Tozan Railway Line 📍200 people 📍600~1,300 yen 📍Not required 📍Not required (—) 📍—



59.Japanese Confectionery Mirakuan



Specializing in *wagashi* (Japanese sweets), this shop not only sells wagashi but also offers a very popular wagashi making session in which you can make the shape of flowers or fruits using sweet red bean paste – and eat it.

☎+81(0)465-62-5577 ☎Shop 8:30~18:00 Workshop 10:30~11:30, 14:00~15:00 ☎Tue 📍230 Miyakami, Yugawara-machi, Ashigarashimo County 📍5 min by bus from Yugawara Sta on JR Line 📍40 people 📍Workshop: 1,404 yen 📍Required 📍Required (Phone, E-mail: info@mirakuan.com) 📍3 days prior to visit



60.Living National Treasure Museum



This is Japan's first art museum featuring exclusively living national treasures. A complimentary cup of tea served in a cup made by a famous artist, possibly a living national treasure, is offered to visitors.

☎+81(0)465-62-2112 ☎9:30~17:00 (admission until 16:30) ☎Open 365 days 📍3-16-1 Chuo, Yugawara-machi, Ashigarashimo County 📍15 min from Yugawara Sta on JR Line 📍30 people 📍200~1,000 yen 📍Required 📍Required (Email: nikobi@i-younet.ne.jp) 📍1 month prior to visit



61.Kominka Yamajutei



This mansion of a wealthy farmer built in 1883 can tell us about architecture in the early Meiji period. The main building and gate have been registered on the list of tangible cultural properties.

☎+81(0)46-285-6958 ☎9:00~17:00 ☎Tue and other days 📍485-1 Nakatsu, Aikawa-machi, Aiko County 📍40 min by bus from Honatsugi Sta on Odakyu Line, "Kyokumae" stop 📍Max. 30 people 📍Free 📍Required 📍Required (Phone) 📍1 week prior to visit



Nature



Required Time for Experience /tour

Chinese English Multilingual support availability on telephone inquiry

☎Telephone number ☎Open hours ☎Closed

📍Address 📍Access

📍Maximum capacity (persons) ☎Admission

📍Necessity of interpretation

📍Necessity of reservation 📍How to make a reservation 📍Reservation deadline



63.Yokohama Hakkeijima Sea Paradise



This island has 4 aquariums and 15 kinds of attractions. Various experience-based programs are offered and the program contents can be modified upon request.

☎+81(0)45-788-9632 ☎Varies according to the season ☎Open 365 days 📍Hakkeijima, Kanazawa-ku, Yokohama City 📍Just outside Hakkeijima Sta on Yokohama Seaside Line 📍Varies according to the course 📍Please ask the staff 📍Required 📍Required (Phone) 📍1 month prior to visit



65.Ikuta Ryokuchi Rose Garden



Feeling sunshine filtering through the trees in the flower garden completely surrounded by greenery, you can enjoy looking at gorgeous colorful roses.

☎+81(0)44-200-2406 ☎Only in spring and autumn (ask the staff) ☎Open 365 days during the open period 📍2-8-1 Nagao, Tama-ku, Kawasaki City 📍5 min by bus from Mukogaoka Yuen Sta on Odakyu Line 📍— 📍Free 📍Required 📍Not required (—) 📍—

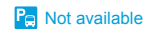

62.Orbi Yokohama



This indoor amusement park creates a world of nature and animals with the harmony of virtual (images) and real (live animals), which you can experience with your five senses.

☎+81(0)45-319-6543 ☎Mon~Thur 9:00~21:00 (admission until 20:00) Fri~Sun, Holidays, Days before holidays 10:00~22:00 (admission until 21:00) ☎No fixed holidays 📍3-5-1 Minatomirai, Nishi-ku, Yokohama City 📍Connected to Minatomirai Sta on Minatomirai Line 📍About 500 people 📍Please ask the staff 📍Not required 📍Required (FAX) 📍3 days prior to visit



64.Yokohama Zoological Gardens ZOORASIA



Under the main theme of "cohabitation of lives and harmonization with nature," one of Japan's largest zoos has various kinds of rare animals from all over the world.

☎+81(0)45-959-1000 ☎9:30~16:30 (admission until 16:00) ☎Tue and other days 📍1175-1 Kamishirane-cho, Asahi-ku, Yokohama City 📍15 min by bus from Nakayama Sta on JR, Yokohama Municipal Subway lines 📍Varies according to the course 📍Please ask the staff 📍Required 📍Required (Web) 📍1 month prior to visit



66.Sagamiko Resort Pleasure Forest (Muscle Monster)



This giant climbing attraction is the first of its kind in Asia. The hexagonal tower rising on the top of the mountain has three tiers of athletic areas and a 16-meter high observation deck.

☎— ☎9:00~17:00 (varies according to the day) ☎Ask the staff 📍1634 Wakayanagi, Midori-ku, Sagami-hara City 📍8 min by bus from Sagami Sta on JR Line 📍— 📍1,500 yen 📍Required *For person under 18 yrs. guardian's consent is required. 📍Not required (—) 📍—



67.The Life Museum of Azabu University

Central
Prefecture

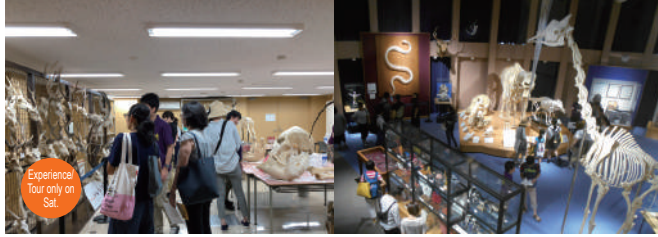

As part of a long-established veterinary university, this museum displays various skeletal preparations of animals as well as research-related and historical materials and records. A popular hands-on corner offers an opportunity to touch real bones of animals to learn more about the animals.

☎+81(0)42-850-2520 ☎10:00~16:00 (admission until 15:30) ☎Mon, Sun and other days
📍1-17-71 Fuchinobe, Chuo-ku, Sagami-hara City 📍5 min walk from Yabe Sta on JR Line
📖Exhibition Hall: No particular limitation Experience: 20~30 people ☎Free ☎Please ask the staff * Required Time for Experience Within opening hours on Sat ☎Required (Phone, Web, Email: museum@azabu-u.ac.jp) 📅2 week prior to visit 📍Please ask the staff

69.Nagai Seaside Park Soleil Hill

Yokosuka
Miura



In this large park with many flowers blossoming in season, you can enjoy various experiences, including harvesting vegetables, coming into contact with animals, and *monozukuri* – making things.

☎+81(0)46-857-2500 ☎Mar~Nov 9:00~18:00 Dec~Feb 9:30~17:00 ☎Open 365 days
📍4 Nagai, Yokosuka City 📍15 min by bus from Misakiguchi Sta on Keikyu Line 📍120 people ☎No admission fee, additional fee for other facilities ☎Required
☎Required (Phone) 📅2 week prior to visit 📍Available

71.Kanagawa Prefectural Museum of Natural History

Western
Prefecture



This museum nicely shows the 4.6 billion year-history of the earth, the diversity of life, and nature in Kanagawa Prefecture through a comprehensive display of about 10,000 real specimens of various creatures, from insects to dinosaurs.

☎+81(0)465-21-1515 ☎9:00~16:30 (admission until 16:00) ☎Mon and other days
📍499 Iryuda, Odawara City 📍3 min walk from Iriuda Sta on Hakone Tozan Railway Line
📖No particular limitation ☎520 yen and others ☎Required
☎Not required (—) 📅— 📍Available

68.Kannonzaki Nature Museum

Yokosuka
Miura



You can see exhibitions of plants and animals living in the Miura Peninsula. The most popular exhibition is a touch pool where you can touch ocean creatures. It also offers a hands-on session to make a preserved specimen of seaweeds.

☎+81(0)46-841-1533 ☎9:00~17:00 (admission until 16:30) ☎Mon and other days, Jul-Aug: open 365 days 📍4-1120 Kamoi, Yokosuka City 📍10 min by bus from Uraga Sta on Keikyu Line 📍100 people ☎200~400 yen, 500 yen additional fee for seaweed specimen ☎Required
☎Required (Phone) 📅5 days prior to visit 📍Available

70.Kanagawa Prefectural Center of Flowers and Greenery, Kana Garden

Shonan



Enjoy seasonal flowers and plants. Various hands-on sessions, such as rice planting and harvesting of various vegetables, are offered according to the growth conditions of receptive plants.

☎+81(0)463-73-6170 ☎9:00~17:00 (Please ask the staff) ☎July, Aug, Dec~Feb: Wed, Dec 28—Jan 4 📍496-1 Teradanawa, Hiratsuka City 📍20 min by bus from Hiratsuka Sta on JR Line, Hadano Sta on Odakyu Line 📍10 people ☎300~520 yen and others Workshop: 150 yen and other (Please ask the staff) ☎Required
☎Required (Phone) 📅1 month prior to visit 📍Available

72.Koajiro-no-mori Forest

Yokosuka
Miura



This forest is called the "miracle forest," because it is the only forest in the Kanto area in which the drainage basin remains intact across the whole area, including forests, rivers, and tidal flats.

☎ — ☎Apr~Sep 7:00~18:00 Oct~Mar 7:00~17:00 ☎Open 365 days ☎Koajiro, Misaki-machi, Miura City 📍4 min by bus from Misakiguchi Sta on Keikyu Line ☎No particular limitation ☎Free ☎Required *fee-charging walk guide is available
☎Not available (—) 📅— 📍Not available

73.Ninomiya Town Tourist Association (seine fishing)

Western
Prefecture



See the blessings from the bountiful ocean at Ninomiya Town. Enjoy being a fisherman at our hands-on seine fishing session.

☎+81(0)463-73-1208 ☎Please ask the staff ☎Dec 1~Mar 14 📍Near 92 Ninomiya, Ninomiya-machi, Naka County 📍10 min walk from Ninomiya Sta on JR Line ☎Please ask the staff ☎1 net: 40,000 yen, 2 nets: 70,000 yen ☎Required
☎Required (Phone) 📅Please ask the staff 📍Not available

75.HAKONE GEOMUSEUM

Western
Prefecture



This museum displays the many and various charms of volcanic Mount Hakone, through panels and models describing highlights of Hakone Onsen and Owakudani Valley. A volcano experiment is also offered to group participants.

☎+81(0)460-83-8140 ☎9:00~16:00 ☎Open 365 days 📍1251 Sengokuhara, Hakone-machi, Ashigarashimo County 📍1 min walk from Owakudani Sta on Hakone Ropeway 📍30 people ☎100 yen ☎Please ask the staff
☎Required (Phone) 📅2 weeks prior to visit 📍Available

77.Manazuru Peninsula Tour Boat

Western
Prefecture



During a 30-minute cruise, you can see the Manazuru Peninsula from the ocean, feel the sea breeze, and enjoy feeding seagulls.

☎+81(0)465-68-3255 ☎9:00~17:00 ☎July 27, July 28, Feb 📍1947-42 Manazuru, Manazuru-machi, Ashigarashimo County 📍5 min by bus from Manazuru Sta on JR Line 📍80 people ☎500~1,000 yen ☎Required *Flight may be cancelled due to weather conditions.
☎Required (for 15 people and over) (Phone) 📅1 week prior to visit 📍Available

74.Ninomiya Town Tourist Association (Mandarin orange picking)

Western
Prefecture



You can enjoy picking mandarin oranges from early to late November in a field with a great view of the beautiful countryside.

☎+81(0)463-73-1208 ☎10:00~15:00 ☎Open only in Nov 📍Ishiki, Ninomiya-machi, Naka County 📍10 min by car from Ninomiya Sta on JR Line ☎Please ask the staff
☎300~400 yen ☎Required
☎Required (Phone) 📅Please ask the staff 📍Not available

76.Manazuru Umi-no-gakko (Endo Shell Museum)

Western
Prefecture



You can see and learn about the ocean in the Manazuru Peninsula with its abundant nature. By observing ocean creatures, you can better understand the ocean environment.

☎ — ☎9:00~16:30(admission until 16:00) ☎Thurs, Dec 28~Jan 3 and other days
📍1175 Manazuru, Manazuru-machi, Ashigarashimo County 📍20 min by bus from Manazuru Sta on JR Line ☎Please ask the staff ☎Please ask the staff ☎Required
☎Required (Email: info@discoverblue.org) 📅3 weeks prior to visit 📍Available

78.Hattori Dairy Farm

Central
Prefecture



This farm offers various hands-on experiences in an idyllic landscape. Enjoy various activities, including milking cows, as well as delicious food, such as gelato made from milk from the cows on the ranch.

☎+81(0)46-281-0917 ☎10:00~17:00 ☎Fri. (Nov~Mar) 📍6087 Hanbara, Aikawa-machi, Aiko County 📍30 min by car from Hashimoto Sta on JR, Keio lines ☎Please ask the staff
☎No admission fee, additional fee for workshops ☎Required
☎Not required (—) 📅— 📍Not available

Sport



Required Time for Experience /Tour

Chinese English Multilingual support availability on telephone inquiry

Telephone number Open hours Closed

Address Access

Maximum capacity (persons) Admission

Necessity of interpretation

Necessity of reservation How to make a reservation Reservation deadline

Parking

79.Bank of Yokohama Ice Arena

Yokohama



This facility offers a place for anyone to enjoy skating, with an internationally standardized main rink and a sub rink for beginners.

+81(0)45-411-8008 10:00~18:30 No fixed holidays 1-1 Hirodaotomachi, Kanagawa-ku, Yokohama City 5 min from Higashi-Kanagawa Sta on JR Line, Tanmachi Sta on Tokyu line 200 people 700~1,600 yen Required *Not available, but a short lesson of skating is available on Saturdays, Sundays, and holidays only *Proper attire is required. * No accident insurance Required (for 20 people and over) (Phone, Email) 2 month prior to visit Available

80.YOKOHAMA STADIUM

Yokohama



Commonly called “hama-suta,” this is Japan’s first multipurpose stadium and the home field for the Yokohama DeNA Baystars Nippon Professional Baseball team. It also holds amateur baseball games and various concerts.

10:00~18:00 Please ask the staff Yokohama Koen, Naka-ku, Yokohama City 2 min walk from Kannai Sta on JR Line 100~1000 yen Required (except English) Required (for 20 people and over) (Phone: +81(0)45-477-5008) Not available

81.Budo Karate (martial art and karate) Imai Dojo

Yokohama



This large-scale *dojo* training hall gives you an opportunity to get a glimpse into the secrets of karate. A trial training course is offered for 2,000 yen for 2 hours.

+81(0)45-341-3966 7:00~22:00 Please ask the staff 223-1 Yamashita-cho, Naka-ku, Yokohama City 5 min walk from Kannai Sta on JR, Yokohama Municipal Subway lines 50 people 2,000 yen Not required *Proper attire is required. Required (Phone, Web, Email) 2 days prior to visit Not available

82.Nissan Stadium

Yokohama



A “World Cup Stadium Tour” is offered to allow you to go around the stadium that served as the stage for the final match of 2002 FIFA World Cup™ through the eyes of a player.

+81(0)45-477-5000 Tour opening (1) 10:30 (2) 12:00 (3) 13:30 (4) 15:00 Tue and other days 3300 Kozukue-cho, Kohoku-ku, Yokohama City 5 min walk from Kozukue Sta on JR Line No particular limitation 200~500 yen Required (except English) Required (for 20 people and over) (Phone: +81(0)45-477-5008) Available

83.SNOVA MIZONOKUCHI-R246

Kawasaki



You can play in snow anytime of the year on this urban indoor slope. It offers a trial session with a rental ski/snowboard (up to about 30 people per session).

+81(0)44-844-1181 Weekdays 12:00~23:00 (sledding 10:00~12:00) Weekends and Holidays 9:00~21:00 Jan 1 and other days 5-28-1 Shimosakunobe, Takatsu-ku, Kawasaki City 2 min walk from Tsudayama Sta on JR Line Sled: 100 people Ski or Snowboard: 30 people 1,000~5,300 yen Required *Proper attire is required. Required (Phone) 1 month prior to visit Available

84.Sagamihara Gion Stadium (Sagamihara Asamizo Park Stadium)

Central Prefectural



With a 400-m track, natural grass field, and stands with a maximum capacity of 15,300, this stadium also hosts official games, such as J-league soccer games.

+81(0)42-777-6088 8:30~19:00 Open 365 days 4169 Shimomizo, Minami-ku, Sagami-hara County 20 min walk from Harataima Sta on JR Line No particular limitation 130~260 yen Required Not required (—) Available

86.Forest Adventure Odawara/Hakone

Western Prefectural



Walk in the air in the forest and have a thrilling experience of sliding down on a cable at our outdoor activities.

9:00~17:00 No fixed holidays Please ask the staff 2,300~3,600 yen Required Required (Phone, Web) Available on the visit day if vacant *Please check the facility information from the website. http://forest-aventure.jp/eng/ Please ask the staff

85.Shonan Bellmare Hiratsuka Beach Park by shonanzoen

Shonan



Equipped with shower facilities, washrooms, and shops, this future-oriented beach is a place you can enjoy beach and marine sports and activities throughout the year.

+81(0)463-23-4781 Apr-Sep 9:00~18:00 Oct, Mar 9:00~17:00 Nov-Feb 9:00~16:30 Oct-Mar: Mon and other days 33-1 Takahamadai, Hiratsuka City 5 min by bus from Hiratsuka Sta on JR Line 1,000~2,000 people during events Varies according to the program Required *Experience/Tour Varies according to the season Required (for 20 people and over)(Phone) 1 week prior to visit Not available

87. Miura Umikaze Bike Rental

Yokosuka /Miura



In the Miura Peninsula, which is readily accessible from Tokyo, you can enjoy fresh seafood and great views while cycling along the coastline.

+81(0)46-874-4945 May-Aug 9:00~18:30 Mar-Apr, Sep-Oct 9:00~18:00 Nov-Feb 9:00~17:30 No fixed holidays 3316-4 Kamimiyada Minamishitaura-machi, Miura City 5 min walk from Miurakaigan Sta on Kei-kyu Line 5 people 1700 yen~ Required *If you want to ride the vehicle, write down your height in the application form. Required (Web, Email) The day before visit Not available





いっしょに
ようこそ♡
ムハンマド・エズジビル・ハサナ
ムハンマド・ルン・エ・サハ

Recommended Routes

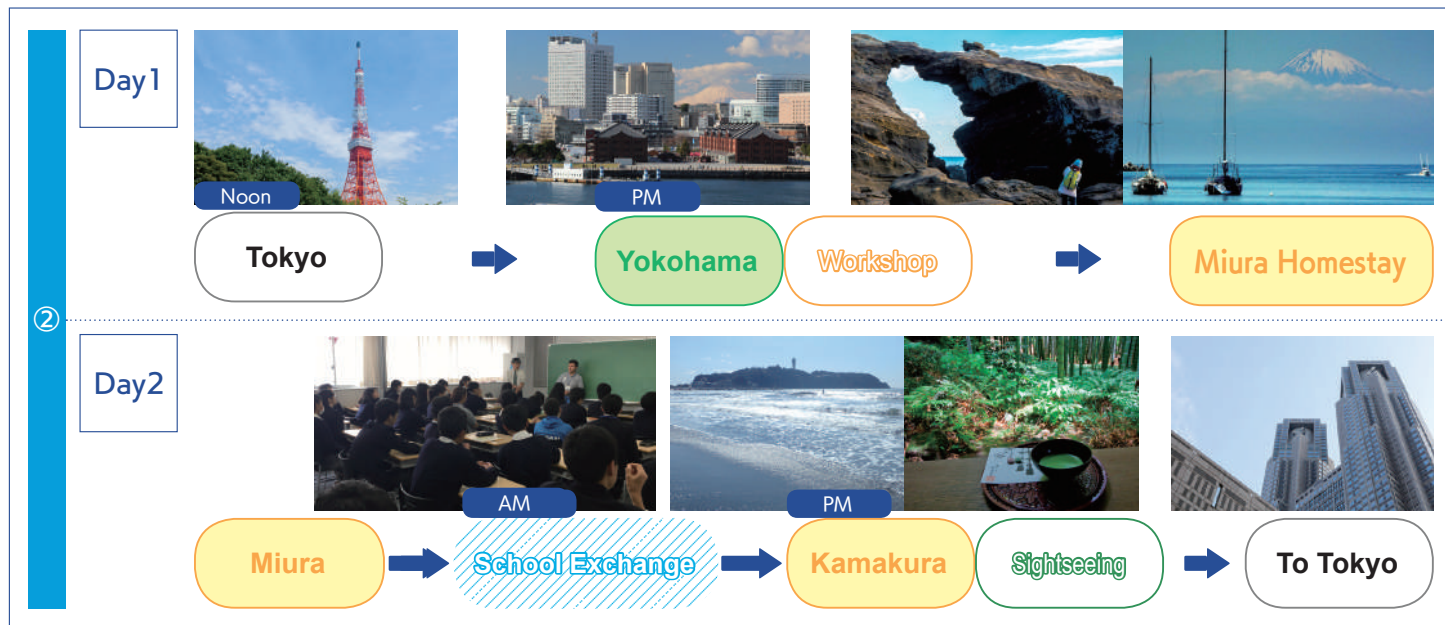

Process of School Introduction

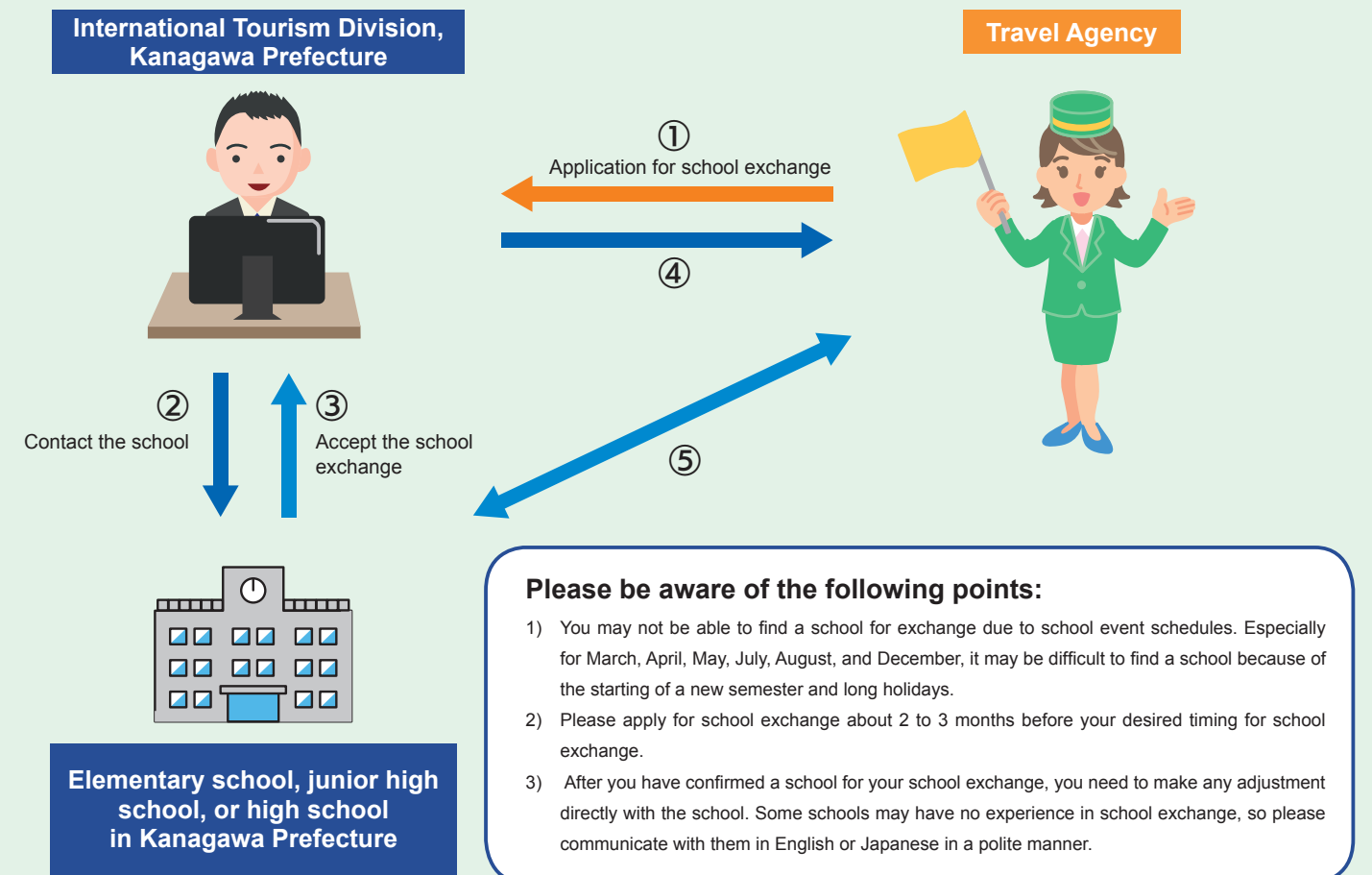

Contact:

International Tourism Division, Tourism Department, International Cultural Tourism Bureau, Kanagawa Prefectural Government

Contact: Tel: +81(0)45-210-4046 (Call in Japanese only)

mail: i-tourism@pref.kanagawa.jp

1 Nihonodori, Naka-ku, Yokohama City, Kanagawa Prefecture, 231-8588

Tokyo Day Trip
- Kanagawa Travel Info -

URL <https://trip.pref.kanagawa.jp/>





Publisher

International Tourism Division,
Tourism Department, International Cultural Tourism Bureau,
Kanagawa Prefectural Government



URL

<https://trip.pref.kanagawa.jp/>

